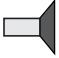
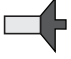

# BONDED SEALS

MAX TYPE	PRODUCT NAME	SEAL PROFILE	APPLICATION	PRESSURE (max) bar	TEMPERATURE	SPEED m/s	PAGE NO
B01	BONDED SEAL		STATIC	1000	-30°C TO +100°C	0.5	443
B02	BONDED SEAL		STATIC	1000	-30°C TO +100°C	0.5	447

## DETAILS

B01 consists of a metal washer with a rectangular cross-section and an elastomer sealing lip with a trapezoidal cross-section that is vulcanized to the inside. When a bolt is tightened, the metal ring resists the bursting forces and limits the deformation of the elastomer sealing ring. Under such a state, the elastomer sealing ring not only has a preload pressure on the mating surface higher than the pressure being sealed but also forms the profile of a U-ring to withstand higher pressures.

## COMPATIBILITY

Mineral oils, bio oils, water soluble & water glycol fluids.

## APPLICATION

- General purpose seal.
- High pressure resistance applications.

## FEATURES

- Simple, captive assembly.
- Reliable low- and high-pressure sealing.
- Secure sealing.
- Metal Back-up.
- Cost effective solution for bolt/thread sealing.
- Standard dimensions.

## NOTE

Note: B01 Imperial, B01 Cetops (ISO 1179-1973), B01 German, B01 French & B01 Metric sizes are available.

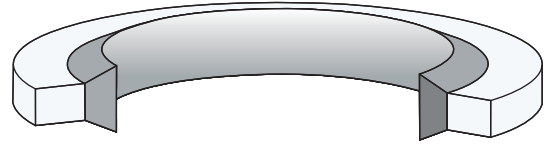

## MATERIAL

Seal Ring : Nitrile Rubber 80/85 Shore A  
FKM Rubber 80/85 Shore A  
Metal : Mild Steel (MS)  
(SS-304/SS-316 on request)

## OPERATING CONDITIONS

Temperature Range : NBR -30°C to + 100°C  
FKM -30°C to + 220°C  
Pressure : 1000 Bar  
Speed : Static

## SURFACE ROUGHNESS

Static : 15.0 μmRa  
Dynamic : 3.2 μmRa

# B01

Bonded Seal (Static Seal)

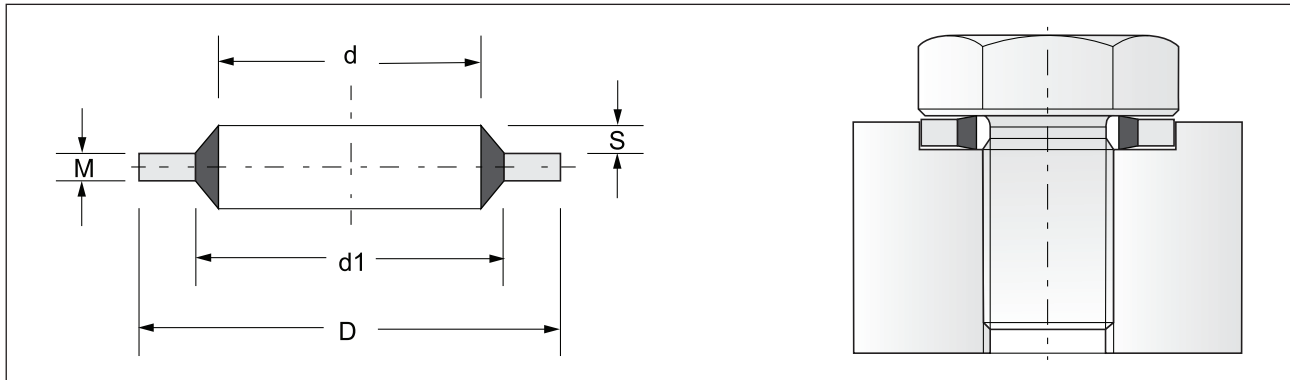

## ORIGINAL RANGE (BRITISH IMPERIAL)

Part No.	Size		D	d1	d	S	M (±0.10)	Min. Burst Pressure (BAR)	Material	Mould No.
	BSP	THREAD								
B010034501	..	6BA	6.35	4.09	3.05	0.20/0.45	1.22	2150	SILICON	SDWY-323
B010041001	..	4BA	7.26	5.26	4.12	0.20/0.45	1.22	1570	NBR	SDWY-751
B010051006	..	2BA	8.38	6.35	5.21	0.20/0.45	1.22	1375	NBR	SDWY-545
B010061001	..	1/4	13.21	8.00	6.86	0.20/0.45	1.22	2450	NBR	
<b>B010066603</b>	..	<b>5/16</b>	<b>13.34</b>	<b>9.53</b>	<b>6.99</b>	<b>0.20/0.45</b>	<b>1.22</b>	<b>1700</b>	<b>FKM</b>	<b>SDWY-109</b>
<b>B010061002</b>	..	<b>5/16</b>	<b>13.34</b>	<b>9.53</b>	<b>6.99</b>	<b>0.20/0.45</b>	<b>1.22</b>	<b>1700</b>	<b>NBR</b>	<b>SDWY-327</b>
B010081002	..	5/16	14.22	10.04	8.64	0.20/0.45	1.22	1750	NBR	SDWY-166
B010101001	1/8	1/8	15.88	11.84	10.37	0.25/0.51	2.03	1500	NBR	SDWY-314
<b>B010106602</b>	1/8	<b>3/8</b>	<b>15.88</b>	<b>11.84</b>	<b>10.37</b>	<b>0.25/0.51</b>	<b>2.03</b>	<b>1500</b>	<b>FKM</b>	<b>SDWY-121</b>
<b>B010111001</b>	..	<b>0.4</b>	<b>18.36</b>	<b>12.45</b>	<b>11.26</b>	<b>0.25/0.51</b>	<b>2.03</b>	<b>1950</b>	<b>NBR</b>	<b>SDWY-476</b>
B010111002	..	7/16	19.05	13.08	11.69	0.25/0.51	2.03	1900	NBR	SDWY-522
<b>B010136601</b>	1/4	<b>1/2</b>	<b>20.57</b>	<b>15.21</b>	<b>13.74</b>	<b>0.25/0.51</b>	<b>2.03</b>	<b>1550</b>	<b>FKM</b>	<b>SDWY-116</b>
<b>B010131001</b>	1/4	<b>1/2</b>	<b>20.57</b>	<b>15.21</b>	<b>13.74</b>	<b>0.25/0.51</b>	<b>2.03</b>	<b>1550</b>	<b>NBR</b>	<b>SDWY-294</b>
B010141011	..	9/16	22.23	16.39	14.86	0.25/0.51	2.03	1575	NBR	SDWY-542
B010151001	..	0.6	22.23	17.30	15.83	0.25/0.51	2.03	1310	NBR	
<b>B010176601</b>	<b>3/8</b>	..	<b>23.80</b>	<b>18.75</b>	<b>17.28</b>	<b>0.25/0.51</b>	<b>2.03</b>	<b>1260</b>	<b>FKM</b>	<b>SDWY-104</b>
<b>B010171001</b>	<b>3/8</b>	..	<b>23.80</b>	<b>18.75</b>	<b>17.28</b>	<b>0.25/0.51</b>	<b>2.03</b>	<b>1260</b>	<b>NBR</b>	<b>SDWY-147</b>
B010161008	..	5/8	25.40	18.75	16.51	0.25/0.51	2.03	1550	NBR	SDWY-578
B010191001	..	3/4	26.92	21.21	19.69	0.25/0.51	2.49	1260	NBR	SDWY-399
<b>B010216601</b>	1/2	<b>13/16</b>	<b>28.58</b>	<b>23.01</b>	<b>21.54</b>	<b>0.25/0.51</b>	<b>2.49</b>	<b>1150</b>	<b>FKM</b>	<b>SDWY-122</b>
<b>B010211001</b>	1/2	<b>13/16</b>	<b>28.58</b>	<b>23.01</b>	<b>21.54</b>	<b>0.25/0.51</b>	<b>2.49</b>	<b>1150</b>	<b>NBR</b>	<b>SDWY-168</b>
<b>B010236601</b>	5/8	<b>7/8</b>	<b>31.75</b>	<b>24.97</b>	<b>23.49</b>	<b>0.25/0.51</b>	<b>2.49</b>	<b>1250</b>	<b>FKM</b>	<b>SDWY-103</b>
<b>B010231001</b>	5/8	<b>7/8</b>	<b>31.75</b>	<b>24.97</b>	<b>23.49</b>	<b>0.25/0.51</b>	<b>2.49</b>	<b>1250</b>	<b>NBR</b>	<b>SDWY-139</b>
B010241001	..	15/16	33.27	26.04	24.26	0.25/0.51	2.49	1275	NBR	SDWY-348
<b>B010276601</b>	<b>3/4</b>	<b>1</b>	<b>34.93</b>	<b>28.53</b>	<b>27.05</b>	<b>0.25/0.51</b>	<b>2.49</b>	<b>1060</b>	<b>FKM</b>	<b>SDWY-588</b>
<b>B010271001</b>	<b>3/4</b>	<b>1</b>	<b>34.93</b>	<b>28.53</b>	<b>27.05</b>	<b>0.25/0.51</b>	<b>2.49</b>	<b>1060</b>	<b>NBR</b>	<b>SDWY-229</b>
B010291001	..	1 1/8	36.58	30.86	29.33	0.25/0.51	2.49	900	NBR	
<b>B010306601</b>	<b>7/8</b>	<b>1 3/16</b>	<b>38.10</b>	<b>32.29</b>	<b>30.81</b>	<b>0.25/0.51</b>	<b>3.38</b>	<b>900</b>	<b>FKM</b>	<b>SDWY-110</b>
<b>B010301001</b>	<b>7/8</b>	<b>1 3/16</b>	<b>38.10</b>	<b>32.29</b>	<b>30.81</b>	<b>0.25/0.51</b>	<b>3.38</b>	<b>900</b>	<b>NBR</b>	<b>SDWY-193</b>
B010271002	..	1 1/16	38.61	30.61	27.82	0.25/0.51	2.49	1250	NBR	
B010321002	..	1 1/4	41.40	35.69	32.64	0.25/0.51	3.38	800	NBR	SDWY-429
<b>B010336601</b>	<b>1</b>	<b>1 5/16</b>	<b>42.80</b>	<b>36.88</b>	<b>33.89</b>	<b>0.25/0.51</b>	<b>3.38</b>	<b>810</b>	<b>FKM</b>	<b>SDWY-120</b>
<b>B010331002</b>	<b>1</b>	<b>1 5/16</b>	<b>42.80</b>	<b>36.88</b>	<b>33.89</b>	<b>0.25/0.51</b>	<b>3.38</b>	<b>810</b>	<b>NBR</b>	<b>SDWY-298</b>
B010351001	..	1 3/8	44.45	38.99	35.94	0.25/0.51	3.38	700	NBR	SDWY-291
B010356601	..	1 3/8	44.45	38.99	35.94	0.25/0.51	3.38	700	FKM	SDWY-291
B010381001	..	1 1/2	47.75	42.04	38.96	0.25/0.51	3.38	700	NBR	SDWY-411
<b>B010426601</b>	<b>1 1/4</b>	<b>1 5/8</b>	<b>52.38</b>	<b>45.93</b>	<b>42.93</b>	<b>0.25/0.51</b>	<b>3.38</b>	<b>690</b>	<b>FKM</b>	<b>SDWY-105</b>
<b>B010421001</b>	<b>1 1/4</b>	<b>1 5/8</b>	<b>52.38</b>	<b>45.93</b>	<b>42.93</b>	<b>0.25/0.51</b>	<b>3.38</b>	<b>690</b>	<b>NBR</b>	<b>SDWY-158</b>
B010451001	..	1 3/4	57.15	45.39	45.34	0.25/0.51	3.38	875	NBR	SDWY-412
<b>B010486601</b>	<b>1 1/2</b>	<b>1 7/8</b>	<b>58.60</b>	<b>51.39</b>	<b>48.44</b>	<b>0.25/0.51</b>	<b>3.38</b>	<b>690</b>	<b>FKM</b>	<b>SDWY-102</b>
<b>B010481001</b>	<b>1 1/2</b>	<b>1 7/8</b>	<b>58.60</b>	<b>51.39</b>	<b>48.44</b>	<b>0.25/0.51</b>	<b>3.38</b>	<b>690</b>	<b>NBR</b>	<b>SDWY-115</b>
B010516601	..	2	63.50	54.74	51.69	0.25/0.51	3.38	780	FKM	SDWY-543
<b>B010546601</b>	<b>1 3/4</b>	<b>2 1/8</b>	<b>69.85</b>	<b>58.30</b>	<b>54.89</b>	<b>0.25/0.51</b>	<b>3.38</b>	<b>950</b>	<b>FKM</b>	<b>SDWY-113</b>
<b>B010541001</b>	<b>1 3/4</b>	<b>2 1/8</b>	<b>69.85</b>	<b>58.30</b>	<b>54.89</b>	<b>0.25/0.51</b>	<b>3.38</b>	<b>950</b>	<b>NBR</b>	<b>SDWY-195</b>
<b>B010601001</b>	<b>2</b>	..	<b>73.03</b>	<b>63.63</b>	<b>60.58</b>	<b>0.25/0.51</b>	<b>3.38</b>	<b>700</b>	<b>NBR</b>	<b>SDWY-171</b>
<b>B010606601</b>	<b>2</b>	..	<b>73.03</b>	<b>63.63</b>	<b>60.58</b>	<b>0.25/0.51</b>	<b>3.38</b>	<b>700</b>	<b>FKM</b>	<b>SDWY-107</b>
B010641001	..	2 1/2	77.72	67.44	64.39	0.25/0.51	3.38	750	NBR	
<b>B010666601</b>	<b>2 1/4</b>	..	<b>79.50</b>	<b>69.98</b>	<b>66.68</b>	<b>0.25/0.51</b>	<b>4.48</b>	<b>670</b>	<b>FKM</b>	<b>SDWY-112</b>
<b>B010661001</b>	<b>2 1/4</b>	..	<b>79.50</b>	<b>69.98</b>	<b>66.68</b>	<b>0.25/0.51</b>	<b>4.48</b>	<b>670</b>	<b>NBR</b>	<b>SDWY-194</b>
<b>B010766601</b>	<b>2 1/2</b>	..	<b>90.17</b>	<b>79.38</b>	<b>76.08</b>	<b>0.25/0.51</b>	<b>3.38</b>	<b>680</b>	<b>FKM</b>	<b>SDWY-106</b>
<b>B010761001</b>	<b>2 1/2</b>	..	<b>90.17</b>	<b>79.38</b>	<b>76.08</b>	<b>0.25/0.51</b>	<b>3.38</b>	<b>680</b>	<b>NBR</b>	<b>SDWY-159</b>
<b>B010891001</b>	<b>3</b>	..	<b>101.47</b>	<b>92.84</b>	<b>89.09</b>	<b>0.25/0.51</b>	<b>3.38</b>	<b>550</b>	<b>NBR</b>	<b>SDWY-220</b>
<b>B010896601</b>	<b>3</b>	..	<b>101.47</b>	<b>92.84</b>	<b>89.09</b>	<b>0.25/0.51</b>	<b>3.38</b>	<b>550</b>	<b>FKM</b>	<b>SDWY-114</b>

Bold sizes are readily available in stock.  
Other materials are available on request.

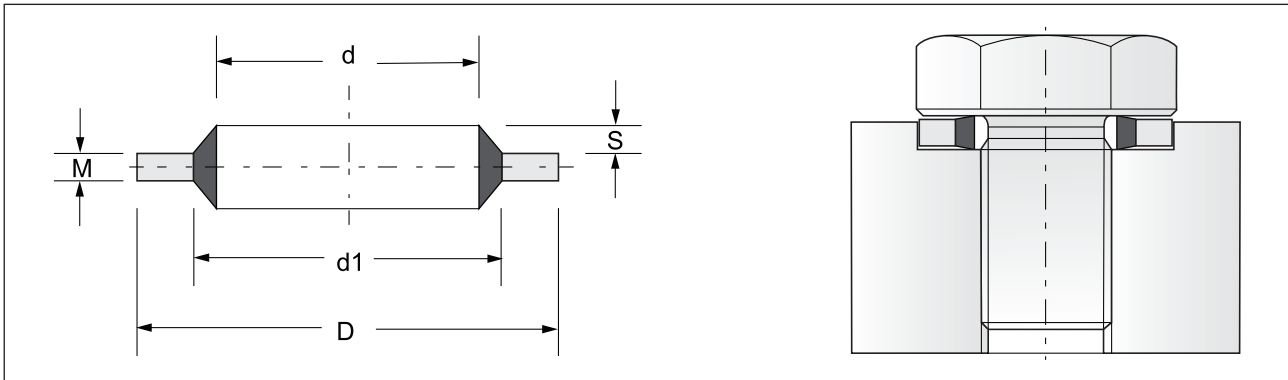

### GERMAN METRIC RANGE

Part No.	Thread Size	D (+0.13)	d1 ( $\pm 0.10$ )	d ( $\pm 0.10$ )	S	M (+0.25)	Min. Burst Pressure (BAR)	Material	Mould No.
B010041001	M3.5	7.20	4.10	5.20	0.30	1.00	1600	NBR	
B010041002	M4	7.00	4.50	5.40	0.30	1.00	1270	NBR	
B010051001	M5	9.00	5.70	6.00	0.30	1.00	1400	NBR	SDWY-370
B010051002	M5	10.00	5.70	7.40	0.30	1.00	1510	NBR	
B010061018	M5.5	9.20	6.20	7.20	0.30	1.00	1220	NBR	
B010061009	M6	10.00	6.70	8.00	0.30	1.00	1120	NBR	SDWY-389
B010061017	M6	11.00	6.70	8.20	0.30	1.00	1480	NBR	SDWY-819
B010061021	M6	11.00	6.70	8.20	0.30	2.50	1480	NBR	
B010071003	M6.5	12.00	7.10	8.80	0.30	1.00	1560	NBR	
B010071002	M6.7	10.20	7.30	8.60	0.30	1.00	850	NBR	SDWY-377
B010081017	M8	13.40	8.50	9.40	0.30	1.00	1780	NBR	SDWY-746
B010081015	M8	13.00	8.70	10.00	0.30	1.00	1330	NBR	
B010081007	M8	14.00	8.70	10.40	0.30	1.00	1510	NBR	SDWY-162
B010081016	M8	16.00	8.70	10.40	0.30	1.00	2150	NBR	
B010091005	M8.5	13.30	9.30	10.50	0.30	1.00	1200	NBR	
B010101023	M10	16.00	10.35	12.00	0.40	2.00	1470	NBR	
<b>B010101005</b>	<b>M10</b>	<b>16.00</b>	<b>10.70</b>	<b>12.40</b>	<b>0.40</b>	<b>1.50</b>	<b>1300</b>	<b>NBR</b>	<b>SDWY-111</b>
<b>B010106606</b>	<b>M10</b>	<b>16.00</b>	<b>10.70</b>	<b>12.40</b>	<b>0.40</b>	<b>1.50</b>	<b>1300</b>	<b>FKM</b>	<b>SDWY-101</b>
B010106603	M10	18.00	10.70	12.40	0.40	1.50	1880	FKM	SDWY-430
B010111003	M11	16.30	11.40	12.70	0.40	1.50	1280	NBR	SDWY-299
B010111010	M11	18.80	11.80	13.70	0.40	1.50	1540	NBR	
B010111011	M11	19.10	11.80	13.50	0.40	1.50	1760	NBR	
B010121016	M12	18.00	12.70	14.40	0.40	1.50	1150	NBR	
B010121002	M12	20.00	12.70	14.40	0.40	1.50	1680	NBR	SDWY-312
B010131013	M13	20.00	13.70	15.40	0.40	1.50	1340	NBR	
B010131004	M13	22.00	13.70	15.40	0.40	1.50	1810	NBR	SDWY-222
B010141017	M13.5	18.70	14.00	15.70	0.40	1.50	900	NBR	
B010141018	M14	22.00	14.70	16.40	0.40	1.50	1510	NBR	
B010161006	M15	22.70	16.00	17.78	0.40	1.50	1260	NBR	
B010166401	M16	24.00	16.70	18.40	0.40	1.50	1370	FKM	SDWY-192
B010171002	M17	24.00	17.40	19.20	0.40	1.50	1150	NBR	
B010181002	M17.5	24.70	18.00	20.10	0.40	1.50	1070	NBR	SDWY-223
B010181003	M18	26.00	18.70	20.40	0.40	1.50	1260	NBR	SDWY-507
B010201001	M20	28.00	20.70	22.50	0.40	1.50	1140	NBR	SDWY-260
B010211014	M21	28.70	21.50	23.30	0.40	2.50	1080	NBR	SDWY-634
B010221012	M22	28.00	22.50	24.20	0.40	1.50	760	NBR	SDWY-646
B010221001	M22	30.00	22.70	24.40	0.40	2.00	1080	NBR	SDWY-218
B010221002	M22	30.00	22.70	24.40	0.40	3.00	1080	NBR	
B010241007	M24	32.00	24.70	26.40	0.40	2.00	1000	NBR	SDWY-562
B010271005	M27	36.00	27.20	29.00	0.40	2.00	1130	NBR	SDWY-387
B010346603	M30	39.00	31.00	33.00	0.40	2.00	870	FKM	SDWY-117
B010336604	M33	42.00	33.70	35.80	0.40	2.00	840	FKM	SDWY-553
B010391007	M33	43.00	34.30	36.40	0.40	2.00	870	NBR	
B010361001	M36	46.00	36.70	38.80	0.40	2.00	890	NBR	SDWY-388
B010401001	M39	51.00	40.00	41.90	0.40	2.50	1030	NBR	SDWY-409
B010421004	M42	53.00	42.70	44.40	0.40	3.00	930	NBR	SDWY-175
B010486602	M48	59.00	48.70	50.80	0.40	3.00	790	FKM	SDWY-471
B010521001	M51	60.00	52.00	54.10	0.40	3.00	540	NBR	
B010531001	M52	64.50	53.30	56.40	0.40	3.00	710	NBR	
B010606603	M60	73.00	60.70	63.00	0.40	3.00	780	FKM	SDWY-557
B010681001	M68	79.50	68.60	72.10	0.40	3.50	510	NBR	
B010761003	M75	90.30	76.08	79.10	0.40	3.38	700	NBR	
B010891003	M88	101.48	89.09	92.10	0.40	3.25	510	NBR	
B011271001	M125	143.67	127.00	132.70	0.40	5.00	420	NBR	SDWY-405

Bold sizes are readily available in stock.

Other materials are available on request.

# B01

Bonded Seal (Static Seal)

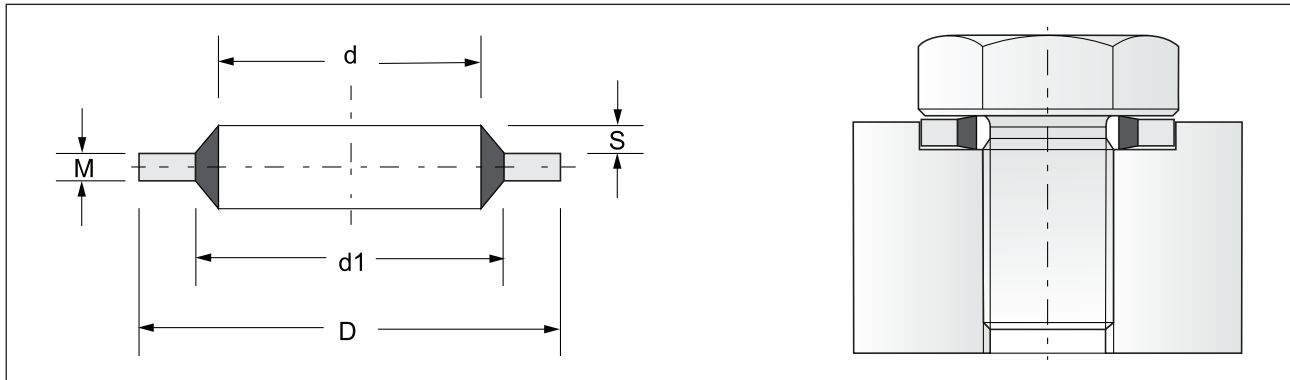

**BONDED SEALS TO SUIT PIPE CONNECTIONS AND COUPLINGS. ISO 1179-1973  
(FORMERLY IN RECOMMENDATIONS)**

Part No.	Thread Size	D (+0.20)	d1 (+0.20)	d (+0.20)	S (+0.25)	M (±0.15)	Min. Burst Pressure (BAR)	Material	Mould No.
B010081003	1/16	12.70	8.30	9.90	0.25	1.25	1100	NBR	SDWY-564
B010101012	1/8	14.70	10.40	12.00	0.25	1.25	930	NBR	SDWY-205
B010131002	1/4	18.70	13.85	15.75	0.25	1.25	790	NBR	SDWY-451
B010171005	3/8	22.70	17.35	19.25	0.25	2.00	775	NBR	SDWY-467
B010211002	1/2	26.70	21.65	23.55	0.25	1.25	580	NBR	SDWY-456
B010271003	3/4	32.50	27.30	29.20	0.25	1.25	500	NBR	SDWY-452
B010341003	1	39.50	34.20	36.10	0.25	2.00	410	NBR	SDWY-276
B010421002	1 1/4	49.50	42.80	44.70	0.25	2.00	500	NBR	SDWY-453
B010481007	1 1/2	55.50	48.70	50.60	0.25	2.00	430	NBR	SDWY-468
B010601002	2	68.50	60.50	62.40	0.25	2.00	450	NBR	

**FRENCH METRIC RANGE**

Part No.	Thread Size	D (+0.13)	d1 (±0.10)	d (±0.10)	S	M (+0.25)	Min. Burst Pressure (BAR)	Material	Mould No.
B010031001	M3	7.50	3.60	5.00	0.30	1.00	1950	NBR	SDWY-417
B010041003	M4	9.00	4.60	6.00	0.30	1.00	2000	NBR	
B010056401	M5	10.00	5.60	7.00	0.30	1.00	1780	FKM	SDWY-354
B010061019	M6	11.00	6.60	8.00	0.30	1.00	1680	NBR	
B010061020	M6	13.27	6.85	8.00	0.30	1.00	1970	NBR	
B010071004	M6	11.40	7.00	8.40	0.30	1.00	1540	NBR	SDWY-475
B010081009	M8	13.00	8.60	10.00	0.30	1.00	1330	NBR	SDWY-254
B010101022	M10	17.00	10.70	12.10	0.40	1.50	1730	NBR	SDWY-820
B010116601	M11	18.10	11.80	13.20	0.40	1.50	1600	FKM	SDWY-458
B010121017	M12	19.00	12.70	14.10	0.40	1.50	1530	NBR	SDWY-474
B010131013	M13	20.10	13.80	15.20	0.40	1.50	1440	NBR	
B010146604	M14	21.00	14.70	16.10	0.30	1.50	1370	FKM	SDWY-548
B010166404	M16	23.00	16.70	18.10	0.30	1.50	1240	FKM	SDWY-675
B010171015	M16.5	23.90	17.20	18.70	0.40	2.10	1020	NBR	
B010171016	M17	23.70	17.40	18.80	0.40	1.50	1200	NBR	
B010186603	M18	27.00	18.70	20.40	0.30	2.00	1450	FKM	SDWY-586
B010206701	M20	29.00	20.70	22.40	0.30	2.00	1340	FKM	SDWY-783
B010211005	M21	30.00	21.70	23.40	0.40	2.00	1290	NBR	SDWY-613
B010226701	M22	31.00	22.70	24.40	0.40	2.00	1240	FKM	SDWY-782
B010231002	M23	32.00	23.70	25.40	0.40	2.00	960	NBR	
B010246603	M24	33.00	24.70	26.40	0.40	2.00	1160	FKM	SDWY-550
B010271010	M26	35.30	27.00	28.70	0.40	2.00	870	NBR	SDWY-390
B010271023	M27	36.00	27.70	29.40	0.40	2.00	1060	NBR	
B010281001	M28	36.00	28.60	30.30	0.40	2.00	730	NBR	
B010291001	M28.5	37.50	29.20	30.90	0.40	2.00	810	NBR	
B010306603	M30	39.00	30.70	32.40	0.40	2.00	970	FKM	SDWY-552
B010336604	M33	42.00	33.70	35.40	0.40	2.00	900	NBR	SDWY-553
B010376601	M36	48.00	37.00	35.40	0.40	2.50	1010	FKM	SDWY-554
B010401001	M39	51.00	40.00	39.60	0.40	2.50	950	NBR	SDWY-409
B010436601	M42	54.00	43.00	42.60	0.40	2.50	890	FKM	SDWY-555
B010466601	M45	57.00	46.00	48.60	0.40	2.50	860	FKM	SDWY-556
B010496601	M48	60.00	49.00	51.60	0.40	2.50	790	FKM	SDWY-527

## DETAILS

B02 Bonded seals are designed with an additional rubber lip than B01 type, making them self-centering. B02 has developed to eliminate the occurrence of leakage due to seal offset, the self-centering type bonded seal has the additional benefit of pre-assembling on to threads with the consequent production line savings. The thin seal membrane offers little resistance during assembly.

## COMPATIBILITY

Mineral oils, bio oils, water soluble & water glycol fluids.

## APPLICATION

- General purpose seal.
- High pressure resistance applications.

## FEATURES

- Simple, captive assembly.
- Ability to pre-assemble.
- Concentrically located.
- Reliable low- and high-pressure sealing.
- Secure sealing.
- Metal Back-up.
- Cost effective solution for bolt/thread sealing.
- Standard dimensions.

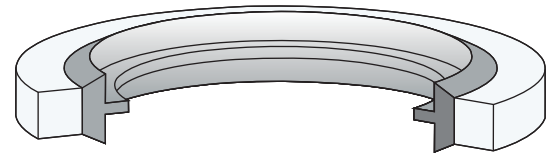

## MATERIAL

Seal Ring : Nitrile Rubber 80/85 Shore A  
FKM Rubber 80/85 Shore A  
Metal : Mild Steel (MS)  
(SS-304/SS-316 on request)

## OPERATING CONDITIONS

Temperature Range : NBR -30°C to + 100°C  
FKM -30°C to + 220°C  
Pressure : 1000 Bar  
Speed : Static

## SURFACE ROUGHNESS

Static : 15.0 μmRa  
Dynamic : 3.2 μmRa

# B02

Bonded Seal (Self Centering)

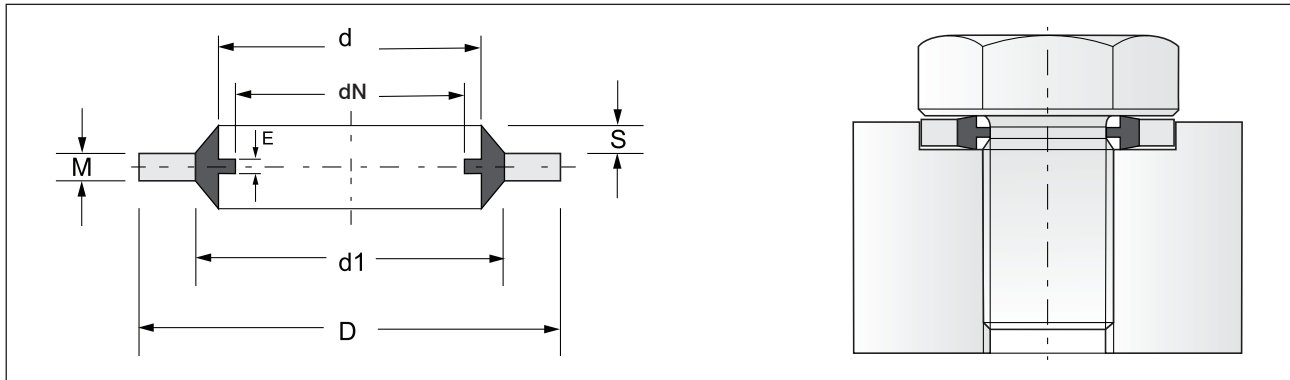

Part No.	Thread Size BSP	D (+0.13)	d1 (±0.10)	d (±0.13)	dN (±0.10)	E	S	M (±0.10)	Material	Mould No.
B020081003	1/8	15.88	11.84	10.37	8.26	0.38/0.63	0.25/0.51	2.03	NBR	SDWY-436
B020116602	1/4	20.57	15.21	13.74	11.18	0.38/0.63	0.25/0.51	2.03	FKM	SDWY-636
B020121001	5/8	25.40	18.75	16.51	12.90	0.38/0.63	0.25/0.51	2.03	NBR	SDWY-439
B020141001	3/8	23.80	18.75	17.28	14.76	0.38/0.63	0.25/0.51	2.03	NBR	SDWY-438
B020186401	1/2	28.58	23.01	21.54	18.24	0.38/0.63	0.25/0.51	2.49	FKM	SDWY-829
B020181004	1/2	28.58	23.01	21.54	18.24	0.38/0.63	0.25/0.51	2.49	NBR	SDWY-440
B020201001	5/8	31.75	24.97	23.49	20.27	0.38/0.63	0.25/0.51	2.49	NBR	SDWY-441
B020231002	3/4	34.93	28.53	27.05	23.83	0.38/0.63	0.25/0.51	2.49	NBR	SDWY-480
B020271003	7/8	38.10	32.29	30.81	27.51	0.38/0.63	0.25/0.51	2.49	NBR	SDWY-807
B020296401	1	42.80	36.88	33.89	29.92	0.38/0.63	0.25/0.51	3.38	FKM	SDWY-442
B020291001	1	42.80	36.88	33.89	29.92	0.38/0.63	0.25/0.51	3.38	NBR	SDWY-442
B020381002	1.1/4	52.38	45.93	42.93	38.45	0.38/0.63	0.25/0.51	3.38	NBR	SDWY-443
B020441002	1.1/2	58.60	51.39	48.44	44.45	0.38/0.63	0.25/0.51	3.38	NBR	SDWY-444
B020501001	1.3/4	69.85	58.30	54.89	50.42	0.38/0.63	0.25/0.51	3.38	NBR	SDWY-544
B020561002	2	73.03	63.63	60.58	56.26	0.38/0.63	0.25/0.51	3.38	NBR	SDWY-445
B020621001	2.1/4	79.50	69.98	66.68	62.36	0.38/0.63	0.25/0.51	3.38	NBR	
B020711001	2.1/2	90.17	79.38	76.08	71.50	0.38/0.63	0.25/0.51	3.38	NBR	

Part No.	Thread Size	D (+0.13)	d1 (±0.10)	d (±0.13)	dN (±0.10)	E	S	M (±0.10)	Material	Mould No.
B020031002	M4	7.00	5.40	4.50	3.40	0.38/0.63	0.25/0.51	1.00	NBR	
B020041002	M6	11.00	8.00	6.60	4.70	0.38/0.63	0.25/0.51	1.00	NBR	
B020061021	M8	14.00	10.40	8.70	6.40	0.38/0.63	0.25/0.51	1.00	NBR	
B020081002	M10	16.00	12.40	10.70	8.05	0.38/0.63	0.25/0.51	1.50	NBR	SDWY-794
B020091001	M12	19.00	14.10	12.70	9.73	0.38/0.63	0.25/0.51	1.50	NBR	
B020116603	M14	22.00	16.40	14.70	11.38	0.38/0.63	0.25/0.51	1.50	FKM	SDWY-635
B020131001	M16	24.00	18.40	16.70	13.50	0.38/0.63	0.25/0.51	1.50	NBR	SDWY-603
B020141001	M18	26.00	20.40	18.70	14.76	0.38/0.63	0.25/0.51	1.50	NBR	
B020161001	M20	28.00	22.40	20.70	16.76	0.38/0.63	0.25/0.51	1.50	NBR	
B020181004	M22	30.00	24.40	22.70	18.74	0.38/0.63	0.25/0.51	2.00	NBR	
B020201001	M24	32.00	26.40	24.70	20.11	0.38/0.63	0.25/0.51	2.00	NBR	
B020361001	M42	54.00	45.60	43.00	36.50	0.38/0.63	0.25/0.51	2.50	NBR	

INTRODUCTION

COMPANY : .....  
 ADDRESS : .....  
 CITY : ..... STATE : ..... COUNTRY : .....  
 CONTACT PERSON : ..... DESIGNATION : ..... PIN CODE : .....  
 PHONE NO. : ..... E-MAIL : .....

NAME OF THE EQUIPMENT : - ..... PRODUCT TYPE ; .....

CORRESPONDING MAX SPARE STYLE : ..... (Ref. Seal Profile Chart)

APPLICATION :  **HYDRAULIC**  **PNEUMATIC** TYPE OF MOTION :  **SINGLE ACTING**  **DOUBLE ACTING**

PRESSURE : MINIMUM OPERATING MAXIMUM TEMPERATURE : MINIMUM OPERATING MAXIMUM  
 ..... BAR ..... BAR ..... BAR .....°C .....°C .....°C

HOUSING TYPE :  **SPLIT**  **SOLID** PISTON TYPE :  **SPLIT**  **SOLID**

EQUIPMENT MOUNTING STYLE :  **HORIZONTAL**  **VERTICAL**  **TELESCOPIC**

EQUIPMENT CONDITION IN SEALING AREA :  **SMOOTH**  **SCORED**  **PITTED**

LENGTH OF STROKE : ..... SEALING MEDIA : .....

ENCLOSED :  EXISTING SAMPLE  PRODUCT DRAWING

**NOMINAL DIMENSIONS DETAILS : -**

PISTON SEALS :- D (CYL. BORE) ..... D1 (PISTON GROOVE DIA) ..... L (GROOVE WIDTH).....

ROD SEALS :- d (ROD DIA) ..... D1 (HOUSING DIA) ..... L (GROOVE WIDTH) .....

WIPER SEALS :- d (ROD DIA) ..... D1 (HOUSING DIA) ..... L (GROOVE WIDTH) .....

GUIDE RINGS :- **PISTON** :- D ..... D1 ..... L .....

**ROD** :- d ..... D1 ..... L .....

O'RING & D (CYL. BORE) ..... D1 (GLAND GROOVE DIA)..... L (GROOVE WIDTH) .....

BACKUP RINGS :-

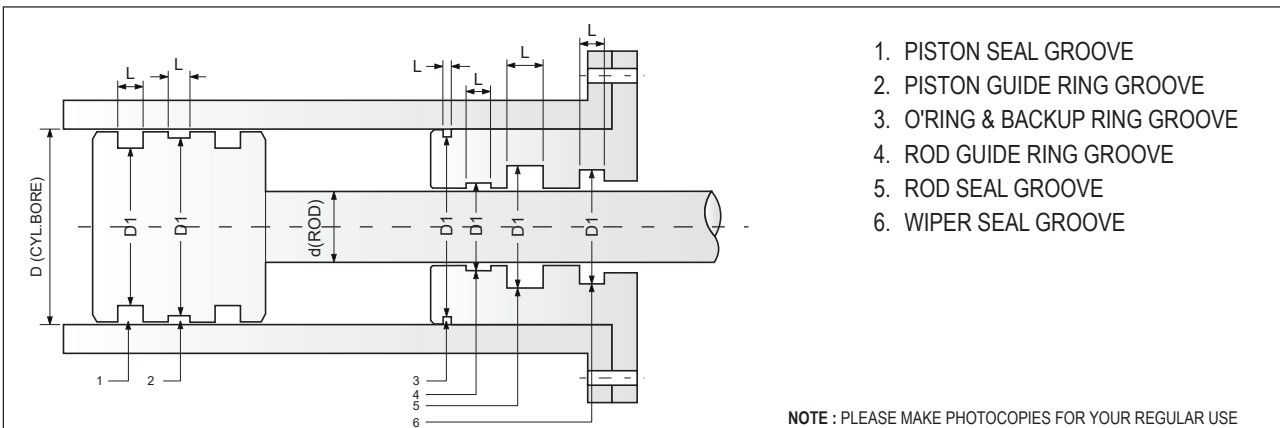

NOTE : PLEASE MAKE PHOTOCOPIES FOR YOUR REGULAR USE

